

# Price list

effective July 1, 2011



GSA price list available upon  
request, please call 1.800.366.6700.  
Contract # GS-28F-7017G

**Fit for the task**

For many American workers, a ‘typical day at the office’ doesn’t include an office. Their workplaces are as unique as the duties they perform.

Cramer serves these workers in challenging task environments, who often require seating with unique features for the demanding work they do.

- Clinical
- Laboratory
- Technical
- Command & Control
- Industrial
- Point of Service

Our line of task chairs and stools offers unparalleled strength, durability and versatility in these markets. And Cramer customers enjoy the same high quality level of service and attention to detail with every order.

When you choose Cramer seating, you can expect:

- **BUILT-TO-ORDER**  
Each chair is made to order, designed to your exact specifications.
- **5 DAY LEAD TIMES**  
Built-to-order doesn’t mean you have to wait. Orders up to 30 units typically ship in five days. (Call regarding larger orders.)
- **SUPERIOR WARRANTIES**  
We invite you to compare. We think you’ll agree – our 10-year and 15-year, three-shift warranties are simply the best in the industry.
- **CUSTOMER CARE**  
Our reps are always available to offer information, assistance or advice. Call them. You’ll be glad you did.



EVER – p.2  
The new standard for challenging environments



TRITON – p.4  
The all-steel workhorse



TRITONMAX – p.6  
The all-steel heavyweight champ



TRITONPLUS – p.8  
The classic Triton with our patented urethane and molded foam



RHINOPLUS – p.10  
The premier lab stool with our patented urethane and molded foam



RHINOPLUS ROUND STOOL – p.12  
The perfect seat plus our patented urethane over molded foam



FUSION – p.14  
The versatile, multi-shift seating choice



ROUND STOOL – p.16  
The classic upholstered stool



RHINO CHAIR – p.18  
The heavy-duty technical chair with molded urethane



RHINO ROUND STOOL – p.20  
The all-around stool with molded urethane



RHINO SIT / STAND – p.22  
The ideal transitional seat



DIMENSION – p.24  
The chair for smaller workspaces



CENTRIS – p.26  
The durable choice for the office worker



ELEVATION PRODUCTS – p.28

ADJUSTMENT GUIDE – p.30

SHIPPING & ORDERING – p.32



Introducing **ever**® – the new standard for strength, versatility and sustainability. With the patent-pending Renewal™ replacement cushion system, you can easily remove and replace the seat cushions, increasing the longevity – and adaptability – of **ever**.

**SPECIFICATIONS:**

**FEATURES:**

- The die-cast aluminum frame guarantees strength and durability.
- The Renewal™ replacement cushion system accommodates the replacement or exchange of multiple cushions sizes on one universal frame; the cushion attach easily with quarter-turn locking fasteners actuated by a Renewal key attached to the bottom of the seat
- Cushion assemblies can be returned to Cramer at no charge for complete recycling
- Multiple cushion sizes fit a range of individuals
- Supports up to 400 lbs.
- The synchro-tilt mechanism provides a smooth, comfortable ride. With 1.7 degrees of back recline for every 1 degree of seat recline and multiple locking positions, it instantly accommodates a broad range of seated positions.
- Intuitive controls allow users to easily select multiple ergonomic postures.
- Generous lumbar support accommodates a variety of body types without adjustment
- 15-Year, Three-Shift Warranty
- **ever** has SCS Indoor Advantage Gold Certification and may help contribute toward LEED certification

**CONSTRUCTION:**

- 26" die-cast aluminum base
- Die-cast aluminum seat pan, frame and arm rests with metal-to-metal connections eliminates points of failure
- Durable, fiberglass-reinforced nylon seat and back assemblies
- High resiliency flame-retardant seat foam with a density of 2.4 lbs. per cubic foot
- Class 4 pneumatic cylinder: 1.12" diameter with a 17-4 taper top end for maximum strength
- Heat-bonded powder coat finish

**OPTIONS:**

- Arms: An adjustable arm option (height range of 6" - 10", inside width range of 18.5" to 22") is available.
- Casters: universal 65MM dual wheel is standard. A hard wheel carpet only caster and non-rolling glides are also available.
- Adjustable 2" seat depth
- TB 133 Fire Code

**DIMENSIONS:**

MODEL#	MAXIMUM OVERALL DIMENSIONS		SEAT DIMENSIONS		SEAT HEIGHT FROM FLOOR WHEN SEATED E	BACK DIMENSIONS		WEIGHT LBS.
	A	B	C	D		F	G	
EMMD1	40.75	30.00	20.00	19.50	17.00 - 21.50	19.50	18.25	46-48
EMLD1	44.75	30.00	20.00	19.50	17.00 - 21.50	19.50	21.50	46-48
ELMD1	40.75	30.00	22.00	19.50	17.00 - 21.50	19.50	18.25	46-48
ELLD1	44.75	30.00	22.00	19.50	17.00 - 21.50	19.50	21.50	46-48

Dimensions listed in inches.  
Adding arms will increase weight by 10 lbs.  
Measurements are for standard mechanisms and can vary +/- .5".

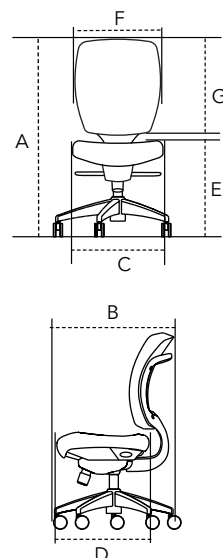

**PRICING:**

Seat Size	Back Size	Adjustment Mechanism	Model Number	List prices by textile grades (see textile card for styles)					
				1	2	3	4	5	6
medium seat	medium back	Synchro	EMMD1	\$1,150	1,166	1,182	1,198	1,214	1,230
	large back	Synchro	EMLD1	\$1,150	1,166	1,182	1,198	1,214	1,230
large seat	medium back	Synchro	ELMD1	\$1,150	1,166	1,182	1,198	1,214	1,230
	large back	Synchro	ELLD1	\$1,150	1,166	1,182	1,198	1,214	1,230

Synchro-tilt - seat height, chair tilt, seat depth (w/ optional seat depth adjustment)

**Renewal™ Replacement Cushions**

	medium back EBM		large back EBL			medium seat ESM			large seat ESL			
TEXTILE GRADE	1	2	3	4	5	6	7	8	9	10	11	12
BACK PRICE	\$172	179	186	193	200	206	216	230	246	263	282	302
SEAT PRICE	\$235	244	254	263	272	281	295	314	335	359	385	412

**OPTIONS:**

ORDER CODE	LIST PRICE	ORDER CODE	LIST PRICE
<b>CASTERS</b>		<b>ENVIRONMENTS</b>	
	<b>universal dual wheel.....standard*</b>	n.	TB 133 .....\$98
1.	carpeted floor only.....n/c	<b>EXTRAS</b>	
3.	non-rolling glide .....n/c	s.	adjustable seat depth option.....\$73
<b>ARMS</b>			
b.	ever adjustable arms .....\$210		

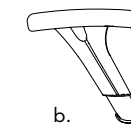

\*Standard casters included unless different options are requested.

**HOW TO ORDER:**

MODEL NUMBER	TEXTILE CODE*	AVAILABLE OPTIONS CODE
<input type="text"/>	<input type="text"/>	<input type="text"/>

\*Refer to Cramer Textile Offering for code. (COM priced at Grade 1)



When you need a chair that outlasts the most demanding environments, think Triton®. Triton's built-to-last construction provides unfailing performance and comfort round-the-clock, earning its reputation as the most durable chair on the market.

## SPECIFICATIONS:

### FEATURES:

- Heavy-duty steel seat and back guarantee multi-shift durability.
- Contoured molded seat with waterfall edge ensures 24-hour comfort
- Dynamic range of adjustments support the full range of seated postures from active forward-leaning to recline
- High performance sure-lock footring with 20" diameter (on stool heights)
- Supports up to 350 lbs.
- 15-Year, Three-Shift Warranty
- Triton has SCS Indoor Advantage Gold Certification and may help contribute toward LEED certification.

### CONSTRUCTION:

- 26" die-cast aluminum base
- 16-gauge steel seat pan
- 16-gauge pressed steel inner back plate with an 18-gauge outer shell
- Integrated steel arm structure with metal-to-metal connections eliminates points of failure
- High resiliency flame-retardant 3" thick seat foam with a density of 2.4 lbs. per cubic foot
- Class 4 pneumatic cylinder: 1.12" diameter with a 17-4 taper top end for maximum strength
- Heat-bonded powder coat finish

### OPTIONS:

- Arms: an intensive use fixed arm option; an adjustable arm option (height range of 6"-10" above seat, inside width range of 19.5"-23"); or a fully articulating arm option w/ slide (adds 3 locking pivot positions, and 2.5" of travel front to back).
- Casters: universal dual wheel is standard. A variety of other casters are also available.
- Rounded footring is standard. Flat surface (mid and high heights only) or fixed (desk height only) are also available.
- Desk, mid, high, and extended range heights
- Upholstered outer back
- Polished aluminum base
- TB 133 Fire Code
- Class 100 Cleanroom, ESD, or CR/ESD Combination
- FNEW83-269 E – includes 14-gauge steel seat pan

### DIMENSIONS:

MODEL#	MAXIMUM OVERALL DIMENSIONS		SEAT DIMENSIONS		SEAT HEIGHT FROM FLOOR WHEN SEATED E	BACK DIMENSIONS		WEIGHT LBS.
	A	B	C	D		F	G	
TRMD4	39.00	27.50	19.50	19.50	16.00 - 20.50	17.25	15.00	51
TRMM4	46.50	27.50	19.50	19.50	21.50 - 29.25	17.25	15.00	56
TRMH4	51.50	27.50	19.50	19.50	24.00 - 34.50	17.25	15.00	57
TRLD4	42.00	27.50	19.50	19.50	16.00 - 20.50	18.00	18.00	56
TRLM4	49.50	27.50	19.50	19.50	21.50 - 29.25	18.00	18.00	61
TRLH4	54.50	27.50	19.50	19.50	24.00 - 34.50	18.00	18.00	62

Dimensions listed in inches.  
Adding arms will increase weight by 10 lbs.  
Measurements are for standard mechanisms and can vary +/- .5".  
Seat slider and arm options can increase overall height and seat height .25" -1"

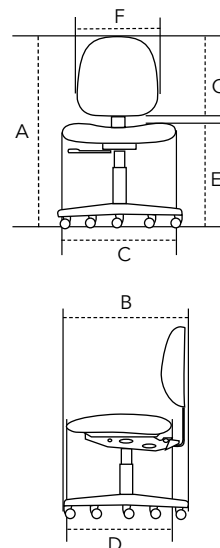

## PRICING:

Chair Style	Back Size	Adjustment Mechanism	Model Number	List prices by textile grades (see textile card for styles)						ESD*
				1	2	3	4	5	6	
desk-height	medium back	4 Way	TRMD4	\$923	939	955	971	987	1,003	1,060
		6 Way	TRMD6	\$986	1,002	1,018	1,034	1,050	1,066	1,123
		7 Way	TRMD7	\$1,037	1,053	1,069	1,085	1,101	1,117	1,174
	large back	4 Way	TRLD4	\$993	1,009	1,025	1,041	1,057	1,073	1,130
		6 Way	TRLD6	\$1,048	1,064	1,080	1,096	1,112	1,128	1,185
		7 Way	TRLD7	\$1,105	1,121	1,137	1,153	1,169	1,185	1,242
mid-height	medium back	4 Way	TRMM4	\$1,011	1,027	1,043	1,059	1,075	1,091	1,148
	large back	4 Way	TRLM4	\$1,069	1,085	1,101	1,117	1,133	1,149	1,206
high-height	medium back	4 Way	TRMH4	\$1,028	1,044	1,060	1,076	1,092	1,108	1,165
	large back	4 Way	TRLH4	\$1,084	1,100	1,116	1,132	1,148	1,164	1,221

4 Way - Seat Height, Back Height, Back Angle, Seat Angle  
6 Way - Seat Height, Back Height, Back Angle, Seat Angle, Chair Tilt, Forward Tilt Limiter  
7 Way - Seat Height, Back Height, Back Angle, Seat Angle, Chair Tilt, Forward Tilt Limiter, Seat Depth

\*Must indicate ESD textile code AND option code q below for chair to perform as ESD

## OPTIONS:

ORDER CODE	LIST PRICE	ORDER CODE	LIST PRICE
<b>CASTERS</b>		<b>FOOTRINGS</b>	
	<b>universal dual wheel.....standard*</b>		<b>high performance rounded footing.....standard*</b>
1.	carpeted floor only.....n/c	x.	high performance flat surface footing.....\$38
3.	non-rolling glide.....n/c	c.	fixed footing (desk height only).....\$44
10.	hard surface single wheel with 3" diameter.....\$66		
<b>ARMS</b>		<b>ENVIRONMENTS</b>	
b.	adjustable arms.....\$160	n.	TB 133.....\$91
t.	articulating arms w/slide.....\$177	p.	cleanroom (must choose a vinyl).....\$65
a.	intensive use fixed arms.....\$180	q.	ESD (must choose ESD textile).....\$170
		r.	cleanroom/ESD (must also choose ESD vinyl).....\$195
		z.	FNEW.....\$103
		<b>EXTRAS</b>	
		e.	polished aluminum base.....\$30
		k.	upholstered outer back.....\$39
		m.	extended range cylinder (approx. 19"-29") (cylinder upcharge added to high-height price).....\$12

\*Standard casters and footrings included unless different options are requested.

## HOW TO ORDER:

MODEL NUMBER	TEXTILE CODE*	AVAILABLE OPTIONS CODE
<input type="text"/>	<input type="text"/>	<input type="text"/>

\*Refer to Cramer Textile Offering for code. (COM priced at Grade 1)



# TRITON®PLUS

**15**  
year  
THREE-SHIFT  
WARRANTY



Need the unfailing performance of Triton® and the superior surface and comfort of Rhino®Plus? You can have them both, with the same great warranty, in Triton®Plus. It just doesn't get any better.

## SPECIFICATIONS:

### FEATURES:

- Patented\* RhinoPlus combination of urethane and molded foam provides a comfortable seat; resists punctures, tears, and virtually all spills; and cleans easily with bleach or ethanol
- Texture provides a non-slip surface
- Heavy-duty steel seat and back guarantee multi-shift durability
- Contoured molded seat with waterfall edge ensures 24-hour comfort
- Dynamic range of adjustments support the full range of seated postures from active forward-leaning to recline
- High performance sure-lock footring with 20" diameter (on stool heights)
- Supports up to 350 lbs
- 15-Year, Three-Shift Warranty
- TritonPlus has SCS Indoor Advantage Gold Certification and may help contribute toward LEED certification.

### CONSTRUCTION:

- 26" die-cast aluminum base
- 16-gauge steel seat pan
- 16-gauge pressed steel inner back plate with an 18-gauge outer shell
- Integrated steel arm structure with metal-to-metal connections eliminates points of failure
- High resiliency flame-retardant 3" thick seat foam with a density of 2.4 lbs. per cubic foot

- Rhino urethane properties: tear strength of 17.7 kgF, puncture resistance of 9.9 kgF, stretch of 660%, abrasion resistance of 25,000, and a Ross Flex rating of 150,000 flexes
- Class 4 pneumatic cylinder: 1.12" diameter with a 17-4 taper top end for maximum strength
- Heat-bonded powder coat finish

### OPTIONS:

- Arms: an intensive use fixed arm option; an adjustable arm option (height range of 6"-10" above seat, inside width range of 19.5"-23"); or a fully articulating arm option w/ slide (adds 3 locking pivot positions, and 2.5" of travel front to back).
- Casters: universal dual wheel is standard. A variety of other casters are also available.
- Rounded footring is standard. Flat surface (mid and high heights only) or fixed (desk height only) are also available.
- Desk, mid, high, and extended range heights
- Polished aluminum base
- Class 100 Cleanroom, ESD, or CR/ESD Combination (ESD option available in 292 Night only)
- FNEW83-269 E – includes 14-gauge steel seat pan

\*U.S. Patent No. 6528002

### DIMENSIONS:

MODEL#	MAXIMUM OVERALL DIMENSIONS		SEAT DIMENSIONS		SEAT HEIGHT FROM FLOOR WHEN SEATED E	BACK DIMENSIONS		WEIGHT LBS.
	A	B	C	D		F	G	
TPMD4	39.00	27.50	19.50	19.50	16.00 - 21.50	17.25	15.00	51
TPMM4	46.50	27.50	19.50	19.50	21.00 - 29.25	17.25	15.00	56
TPMH4	51.50	27.50	19.50	19.50	24.00 - 34.50	17.25	15.00	57
TPLD4	42.00	27.50	19.50	19.50	16.00 - 21.50	18.00	18.00	56
TPLM4	49.50	27.50	19.50	19.50	21.50 - 29.25	18.00	18.00	61
TPLH4	54.50	27.50	19.50	19.50	24.00 - 34.50	18.00	18.00	62

Dimensions listed in inches.  
Adding arms will increase weight by 10 lbs.  
Measurements are for standard mechanisms and can vary +/- .5".  
Seat slider and arm options can increase overall height and seat height .25" -1"

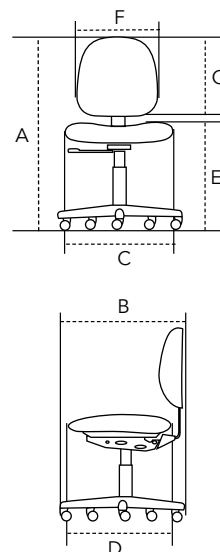

# TRITON®PLUS

## PRICING:

Chair Style	Back Size	Adjustment Mechanism	Model Number	list price
				(choose from 292 Night, 207 Lake, 219 Stone, 225 Wood)
	medium back	4 Way	TPMD4	\$1,022
		6 Way	TPMD6	\$1,070
		7 Way	TPMD7	\$1,122
	large back	4 Way	TPLD4	\$1,077
		6 Way	TPLD6	\$1,140
		7 Way	TPLD7	\$1,190
	medium back	4 Way	TPMM4	\$1,095
	large back	4 Way	TPLM4	\$1,160
	medium back	4 Way	TPMH4	\$1,110
	large back	4 Way	TPLH4	\$1,180

4 Way - Seat Height, Back Height, Back Angle, Seat Angle  
6 Way - Seat Height, Back Height, Back Angle, Seat Angle, Chair Tilt, Forward Tilt Limiter  
7 Way - Seat Height, Back Height, Back Angle, Seat Angle, Chair Tilt, Forward Tilt Limiter, Seat Depth

\*Must indicate ESD textile code AND option code q below for chair to perform as ESD

## OPTIONS:

ORDER CODE	LIST PRICE	ORDER CODE	LIST PRICE
<b>CASTERS</b>		<b>FOOTRINGS</b>	
<b>universal dual wheel.....standard*</b>		<b>high performance rounded footring .....standard*</b>	
1. carpeted floor only.....n/c		x. high performance flat surface footring.....\$38	
3. non-rolling glide.....n/c		c. fixed footring (desk height only).....\$44	
10. hard surface single wheel with 3" diameter.....\$66			
<b>ARMS</b>		<b>ENVIRONMENTS</b>	
b. adjustable arms.....\$160		p. cleanroom.....\$65	
t. articulating arms w/slide.....\$177		q. ESD (only available in 292 night).....\$170	
a. intensive use fixed arms.....\$180		r. cleanroom/ESD (only available in 292 night).....\$195	
		z. FNEW.....\$103	
		<b>EXTRAS</b>	
		e. polished aluminum base.....\$30	
		m. extended range cylinder (approx. 19"-29") (cylinder upcharge added to high-height price).....\$12	



\*Standard casters and footrings included unless different options are requested.

## HOW TO ORDER:

MODEL NUMBER	TEXTILE CODE*	AVAILABLE OPTIONS CODE
<input type="text"/>	<input type="text"/>	<input type="text"/>

\*Refer to Cramer Textile Offering for code. (COM priced at Grade 1)

# RHINO®PLUS

**10**  
year  
THREE-SHIFT  
WARRANTY



# RHINO®PLUS

This stool is built to withstand wear-and-tear from the inside out, providing a unique seating solution for the science, technology and healthcare fields. The patented Rhino®Plus combines urethane with molded foam, creating an unparalleled blend of durability and comfort.

## SPECIFICATIONS:

### FEATURES:

- Patented\* RhinoPlus combination of urethane and molded foam provides a comfortable seat; resists punctures, tears, and virtually all spills; and cleans easily with bleach or ethanol.
- Texture provides a non-slip surface
- The steel inner structure stands up to wear-and-tear throughout multiple shifts
- Contoured molded seat with waterfall edge ensures 24-hour comfort
- Dynamic range of adjustments support the full range of seated postures from active forward-leaning to recline
- High performance sure-lock footring with 20" diameter (on stool heights)
- Supports up to 350 lbs.
- 10-Year, Three-Shift Warranty
- RhinoPlus has SCS Indoor Advantage Gold Certification and may help contribute toward LEED certification.

- Rhino urethane properties: tear strength of 17.7 kgF, puncture resistance of 9.9 kgF, stretch of 660%, abrasion resistance of 25,000, and a Ross Flex rating of 150,000 flexes
- Class 4 pneumatic cylinder: 1.12" diameter with a 17-4 taper top end for maximum strength
- Heat-bonded powder coat finish

### OPTIONS:

- Arms: an intensive use fixed arm option; an adjustable arm option (height range of 6"-10" above seat, inside width range of 19.5"-23"); or a fully articulating arm option w/ slide (adds 3 locking pivot positions, and 2.5" of travel front to back).
- Casters: universal dual wheel is standard. A variety of other casters are also available.
- Rounded footring is standard. Flat surface (mid and high heights only) or fixed (desk height only) are also available.
- Desk, mid, high, and extended range heights
- Painted or polished aluminum base
- Class 100 Cleanroom, ESD, or CR/ESD Combination (ESD available in 292 Night only)

\*U.S. Patent No. 6528002

### CONSTRUCTION:

- 26" fiberglass-reinforced nylon base
- 16-gauge steel seat pan
- Integrated steel arm structure with metal-to-metal connections eliminates points of failure
- High resiliency flame-retardant 3" thick seat foam with a density of 2.4 lbs. per cubic foot

### DIMENSIONS:

MODEL#	MAXIMUM OVERALL DIMENSIONS		SEAT DIMENSIONS		SEAT HEIGHT FROM FLOOR WHEN SEATED	BACK DIMENSIONS		WEIGHT LBS.
	A	B	C	D		F	G	
RPMD2	37.50	27.50	20.00	19.50	16.00 - 21.25	16.75	15.00	32
RPMM2	45.25	27.50	20.00	19.50	20.75 - 28.25	16.75	15.00	34
RPMH2	50.00	27.50	20.00	19.50	22.75 - 33.25	16.75	15.00	35

Dimensions listed in inches.  
Adding arms will increase weight by 10 lbs.  
Measurements are for standard mechanisms and can vary +/- .5".  
Seat slider and arm options can increase overall height and seat height .25" -1"

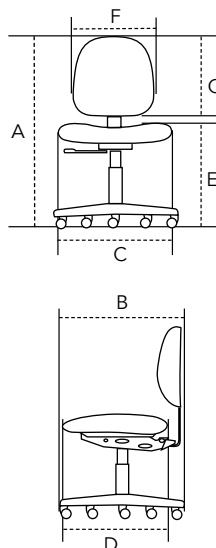

## PRICING:

Chair Style	Back Size	Adjustment Mechanism	Model Number	list price
				(choose from 292 Night, 207 Lake, 219 Stone, 225 Wood)
 desk-height	medium back	2 Way	RPMD2	\$712
		4 Way	RPMD4	\$799
		6 Way	RPMD6	\$860
		7 Way	RPMD7	\$908
 mid-height	medium back	2 Way	RPMM2	\$798
		4 Way	RPMM4	\$883
 high-height	medium back	2 Way	RPMH2	\$813
		4 Way	RPMH4	\$900

2 Way - Seat Height, Back Depth  
4 Way - Seat Height, Back Height, Back Angle, Seat Angle  
6 Way - Seat Height, Back Height, Back Angle, Seat Angle, Chair Tilt, Forward Tilt Limiter  
7 Way - Seat Height, Back Height, Back Angle, Seat Angle, Chair Tilt, Forward Tilt Limiter, Seat Depth

\*Must indicate ESD textile code AND option code q below for chair to perform as ESD

## OPTIONS:

ORDER CODE	LIST PRICE	ORDER CODE	LIST PRICE
<b>CASTERS</b>			
<b>universal dual wheel.....standard*</b>			
1. carpeted floor only.....n/c		x. high performance flat surface footing.....\$38	
3. non-rolling glide.....n/c		c. fixed footing (desk height only).....\$44	
9. weight activated brakes when seated.....\$110		<b>ENVIRONMENTS</b>	
10. hard surface single wheel with 3" diameter.....\$66		p. cleanroom.....\$90	
<b>ARMS</b>			
b. adjustable arms.....\$160		q. ESD (available only in 292 Night).....\$230	
t. articulating arms w/slide.....\$177		r. cleanroom/ESD (available only in 292 Night).....\$260	
a. intensive use fixed arms.....\$180		<b>EXTRAS</b>	
d. painted aluminum base.....\$53			
e. polished aluminum base.....\$78			
m. extended range cylinder (approx. 19"-29") (cylinder upcharge added to high-height price).....\$12			

\*Standard casters and footrings included unless different options are requested.

## HOW TO ORDER:

MODEL NUMBER	TEXTILE CODE*	AVAILABLE OPTIONS CODE
<input type="text"/>	<input type="text"/>	<input type="text"/>

\*Refer to Cramer Textile Offering for code. (COM priced at Grade 1)

# RHINO®PLUS ROUND STOOL

**10**  
year  
THREE-SHIFT  
WARRANTY



Work in a laboratory or healthcare environment is challenging. The Rhino®Plus Round Stool, with its patented RhinoPlus upholstery, provides cushioned comfort while resisting punctures, tears, and virtually all spills. Rhino Plus Round Stool is the premier exam stool on the market.

## SPECIFICATIONS:

### FEATURES:

- Tough, dependable, trouble-free seating anywhere you need it
- Texture provides a non-slip surface
- Our patented\* RhinoPlus combination of urethane and foam provides a comfortable seat; resists punctures, tears, and virtually all spills; and cleans easily
- No chair back to get in the way in tight workspaces
- Hand or foot-activated height adjustment, accessible from any direction
- High performance sure-lock footring with 20" diameter (on hand-activated stool heights)
- Supports up to 350 lbs.
- 10-Year, Three-Shift Warranty

- Rhino urethane properties: tear strength of 17.7 kgF, puncture resistance of 9.9 kgF, stretch of 660%, abrasion resistance of 25,000, and a Ross Flex rating of 150,000 flexes
- Class 4 pneumatic cylinder
- Heat-bonded powder coat finish

### OPTIONS:

- Casters – universal dual wheel is standard. A variety of other casters are also available.
- Rounded footring is standard. Flat surface is also available. Footrings are only available on hand-activated, mid and high-height stools.
- Painted or polished aluminum base
- Desk, mid, high, and extended range heights
- Class 100 Cleanroom option

\*U.S. Patent No. 6528002

### CONSTRUCTION:

- 16-gauge steel seat pan
- 23" fiberglass-reinforced nylon base (hand-activated); 23" die-cast aluminum base (foot-activated)
- High resiliency flame-retardant 2.5" thick seat foam with a density of 2.4 lbs. per cubic foot

### DIMENSIONS:

MODEL#	MAXIMUM OVERALL DIMENSIONS		SEAT DIMENSIONS	SEAT HEIGHT FROM FLOOR WHEN SEATED	WEIGHT LBS.
	A	B	C	D	
RSOD1	20.50	24.50	16.00	15.50 - 20.75	23
RSOM1	27.75	24.50	16.00	20.25 - 27.75	25
RSOH1	32.75	24.50	16.00	22.75 - 32.75	26
RSOF1	23.00	24.50	16.00	17.25 - 22.25	23
RSOG1	29.50	24.50	16.00	21.25 - 28.50	25

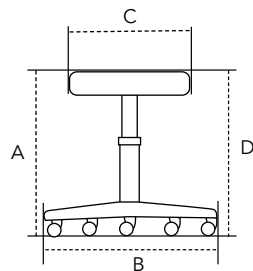

Dimensions listed in inches.

# RHINO®PLUS ROUND STOOL

## PRICING:

Chair Style	Activation Type	Adjustment Mechanism	Model Number	list price (only available in 292 Night and 207 Lake)
 desk-height	hand	1 Way	RSOD1	\$440
	foot	1 Way	RSOF1	\$650
 mid-height	hand	1 Way	RSOM1	\$523
	foot	1 Way	RSOG1	\$672
 high-height	hand	1 Way	RSOH1	\$536

1 Way Adjustment - Seat Height

## OPTIONS:

ORDER CODE	LIST PRICE	ORDER CODE	LIST PRICE
<b>CASTERS</b>		<b>ENVIRONMENTS</b>	
	<b>universal dual wheel.....standard*</b>	p.	cleanroom .....\$65
1.	carpeted floor only .....n/c	<b>EXTRAS</b>	
3.	non-rolling glide .....n/c	d.	painted aluminum base (standard on foot-activated models) .....\$53
7.	weight-activated brakes when not seated .....\$66	e.	polished aluminum base.....\$78
9.	weight-activated brakes when seated .....\$110	m.	extended range cylinder (approx. 19"-29") (cylinder upcharge added to high-height price).....\$12
10.	hard surface single wheel with 3" diameter .....\$66		
<b>FOOTRINGS</b>			
	<b>high performance rounded footring .....standard*</b>		
x.	high performance flat surface footring .....\$38		
c.	fixed footring (desk height only) .....\$44		

\*Standard casters and footrings included unless different options are requested.

Options p and m are available on hand-activated models only.

## HOW TO ORDER:

MODEL NUMBER	TEXTILE CODE*	AVAILABLE OPTIONS CODE
<input type="text"/>	<input type="text"/>	<input type="text"/>
*Refer to Cramer Textile Offering for code. (COM priced at Grade 1)		

# FUSION™



# FUSION™

If you need task seating that can withstand the rigors of multiple shifts while meeting the specific requirements of the science, technology, and healthcare fields, Fusion™ is your versatile, durable choice.

## SPECIFICATIONS:

### FEATURES:

- Heavy-duty steel seat for multi-shift durability
- The steel inner structure stands up to wear-and-tear throughout multiple shifts
- Contoured molded seat with waterfall edge ensures 24-hour comfort
- Dynamic range of adjustments support the full range of seated postures from active forward-leaning to recline
- High performance sure-lock footring with 20" diameter (on stool heights)
- Supports up to 350 lbs.
- 10-Year, Three-Shift Warranty
- Fusion has SCS Indoor Advantage Gold Certification and may help contribute toward LEED certification.

- High resiliency flame-retardant seat foam 3" thick with a density of 2.4 lbs. per cubic foot
- Class 4 pneumatic cylinder: 1.12" diameter with a 17-4 taper top end for maximum strength
- Heat-bonded powder coat finish

### OPTIONS:

- Arms: an intensive use fixed arm option; an adjustable arm option (height range of 6"-10" above seat, inside width range of 19.5"-23"); or a fully articulating arm option w/ slide (adds 3 locking pivot positions, and 2.5" of travel front to back).
- Casters: universal dual wheel is standard. A variety of other casters are also available.
- Rounded footring is standard. Flat surface (mid and high heights only) or fixed (desk height only) are also available.
- Desk, mid, high, and extended range heights
- Painted or polished aluminum base
- TB 133 Fire Code
- Class 100 Cleanroom, ESD, or CR/ESD Combination

### CONSTRUCTION:

- 26" fiberglass-reinforced nylon base
- 16-gauge steel seat pan
- Integrated steel arm structure with metal-to-metal connections eliminates points of failure

### DIMENSIONS:

MODEL#	MAXIMUM OVERALL DIMENSIONS		SEAT DIMENSIONS		SEAT HEIGHT FROM FLOOR WHEN SEATED E	BACK DIMENSIONS		WEIGHT LBS.
	A	B	C	D		F	G	
FSMD4	41.50	27.50	19.50	19.50	16.00 - 21.25	16.25	14.75	32
FSMM4	47.75	27.50	19.50	19.50	20.75 - 28.25	16.25	14.75	34
FSMH4	52.75	27.50	19.50	19.50	22.75 - 33.25	16.25	14.75	35
FSLD4	43.25	27.50	19.50	19.50	16.00 - 21.25	17.50	19.00	34
FSLM4	49.50	27.50	19.50	19.50	20.75 - 28.25	17.50	19.00	35
FSLH4	54.50	27.50	19.50	19.50	22.75 - 33.25	17.50	19.00	37

Dimensions listed in inches.  
Adding arms will increase weight by 10 lbs.  
Measurements are for standard mechanisms and can vary +/- .5".  
Seat slider and arm options can increase overall height and seat height .25" -1"

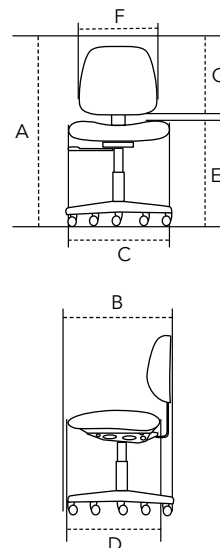

## PRICING:

Chair Style	Back Size	Adjustment Mechanism	Model Number	List prices by textile grades (see textile card for styles)						
				1	2	3	4	5	6	ESD*
	medium back	4 Way	FSMD4	\$741	757	773	789	805	821	878
		6 Way	FSMD6	\$804	820	836	852	868	884	941
		7 Way	FSMD7	\$852	868	884	900	916	932	989
	large back	4 Way	FSLD4	\$809	825	841	857	873	889	946
		6 Way	FSLD6	\$871	887	903	919	935	951	1,008
		7 Way	FSLD7	\$920	936	952	968	984	1,000	1,057
	medium back	4 Way	FSMM4	\$827	843	859	875	891	907	964
	large back	4 Way	FSLM4	\$896	912	928	944	960	976	1,033
	medium back	4 Way	FSMH4	\$845	861	877	893	909	925	982
	large back	4 Way	FSLH4	\$914	930	946	962	978	994	1,051

4 Way - Seat Height, Back Height, Back Angle, Seat Angle  
6 Way - Seat Height, Back Height, Back Angle, Seat Angle, Chair Tilt, Forward Tilt Limiter  
7 Way - Seat Height, Back Height, Back Angle, Seat Angle, Chair Tilt, Forward Tilt Limiter, Seat Depth

\*Must indicate ESD textile code AND option code q below for chair to perform as ESD

## OPTIONS:

ORDER CODE	LIST PRICE	ORDER CODE	LIST PRICE
<b>CASTERS</b>			
<b>universal dual wheel.....standard*</b>			
1. carpeted floor only.....n/c		x. high performance flat surface footing.....\$38	
3. non-rolling glide.....n/c		c. fixed footing (desk height only).....\$44	
9. weight activated brakes when seated.....\$110		<b>ENVIRONMENTS</b>	
10. hard surface single wheel with 3" diameter.....\$66		n. TB 133.....\$91	
<b>ARMS</b>			
b. adjustable arms.....\$160		p. cleanroom (must choose a vinyl).....\$90	
t. articulating arms w/slide.....\$177		q. ESD (must choose ESD textile).....\$230	
a. intensive use fixed arms.....\$180		r. cleanroom/ESD (must also choose ESD vinyl).....\$260	
<b>EXTRAS</b>			
		d. painted aluminum base.....\$53	
		e. polished aluminum base.....\$78	
		k. upholstered back.....\$39	
		m. extended range cylinder (approx. 19"-29") (cylinder upcharge added to high-height price).....\$12	

\*Standard casters and footrings included unless different options are requested.

## HOW TO ORDER:

MODEL NUMBER	TEXTILE CODE*	AVAILABLE OPTIONS CODE
<input type="text"/>	<input type="text"/>	<input type="text"/>

\*Refer to Cramer Textile Offering for code. (COM priced at Grade 1)

# ROUND STOOL®



The Round Stool is a welcome addition to a busy work area. Not just for medical applications, this model is perfect anywhere a versatile, well-padded place to sit will make life a little easier.

## SPECIFICATIONS:

### FEATURES:

- Versatile, dependable, trouble-free seating in three heights
- No chair back to get in the way in tight workspaces
- Contoured foam seat ensures 24-hour comfort
- Hand or foot-activated height adjustment, accessible from any direction
- High performance sure-lock footring with 20" diameter (on hand-activated stool heights)
- Supports up to 350 lbs.
- 10-Year, Three-Shift Warranty

### CONSTRUCTION:

- 16-gauge steel seat pan
- 23" fiberglass-reinforced nylon base (hand-activated); 23" die-cast aluminum base (foot-activated)
- High resiliency flame-retardant 2.5" thick seat foam with a density of 2.4 lbs. per cubic foot
- Class 4 pneumatic cylinder
- Heat-bonded powder coat finish

### DIMENSIONS:

MODEL#	MAXIMUM OVERALL DIMENSIONS		SEAT DIMENSIONS C	SEAT HEIGHT FROM FLOOR WHEN SEATED D	WEIGHT LBS.
	A	B			
RSOD1	20.50	24.50	16.00	15.50 - 20.75	23
RSOM1	27.75	24.50	16.00	20.25 - 27.75	25
RSOH1	32.75	24.50	16.00	22.75 - 32.75	26
RSOF1	23.00	24.50	16.00	17.25 - 22.25	23
RSOG1	29.50	24.50	16.00	21.25 - 28.50	25

Dimensions listed in inches.

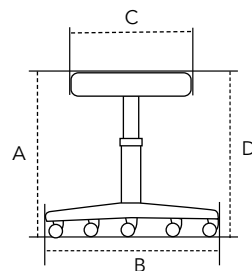

### OPTIONS:

- Casters: universal dual wheel is standard. A variety of other casters are also available.
- Rounded footring is standard. Flat surface is also available. Footrings are only available on hand-activated, mid and high-height stools.
- Desk, mid, high, and extended range heights
- Textile or vinyl upholstery
- Painted or polished aluminum base
- TB 133 Fire Code
- Class 100 Cleanroom, ESD, and CR/ESD Combination (hand-activated)

# ROUND STOOLS®

## PRICING:

Chair Style	Activation Type	Adjustment Mechanism	Model Number	List prices by textile grades (see textile card for styles)						
				1	2	3	4	5	6	ESD*
desk-height	Hand	1 Way	RSOD1	\$365	381	397	413	429	445	502
	Foot	1 Way	RSOF1	\$565	581	597	613	629	645	
mid-height	Hand	1 Way	RSOM1	\$448	464	480	496	512	528	585
	Foot	1 Way	RSOG1	\$584	600	616	632	648	664	
high-height	Hand	1 Way	RSOH1	\$460	476	492	508	524	540	597

1 Way Adjustment - Seat Height

\*Must indicate ESD textile code AND option code q below for chair to perform as ESD

## OPTIONS:

ORDER CODE	LIST PRICE	ORDER CODE	LIST PRICE
<b>CASTERS</b>		<b>ENVIRONMENTS</b>	
	<b>universal dual wheel.....standard*</b>	n.	TB 133 .....\$91
1.	carpeted floor only .....n/c	p.	cleanroom (must choose a vinyl) .....\$65
3.	non-rolling glide .....n/c	q.	ESD (must choose ESD textile) .....\$170
7.	weight-activated brakes when not seated .....\$66	r.	cleanroom/ESD (must also choose ESD vinyl) .....\$195
9.	weight-activated brakes when seated .....\$110		
10.	hard surface single wheel with 3" diameter .....\$66	<b>EXTRAS</b>	
	<b>FOOTRINGS</b>	d.	painting aluminum base (standard on foot-activated models).....\$53
	<b>high performance rounded footring .....standard*</b>	e.	polished aluminum base.....\$78
x.	high performance flat surface footring .....\$38	m.	extended range cylinder (approx. 19"-29") (cylinder upcharge added to high-height price).....\$12
c.	fixed footring (desk height only) .....\$44		

\*Standard casters and footrings included unless different options are requested. Options q, r and m are available on hand-activated models only.

## HOW TO ORDER:

MODEL NUMBER	TEXTILE CODE*	AVAILABLE OPTIONS CODE
<input type="text"/>	<input type="text"/>	<input type="text"/>
*Refer to Cramer Textile Offering for code. (COM priced at Grade 1)		

# RHINO™ CHAIR

**10**  
year  
THREE-SHIFT  
WARRANTY



# RHINO™ CHAIR

When demanding environments need durable, multi-shift seating, Rhino™ Chair meets their unique technical requirements. The durable molded seat and back simply won't quit, and the Rhino skin coating resists most chemical and physical damage.

## SPECIFICATIONS:

### FEATURES:

- Durable Rhino skin is molded right onto the frame.
- Dynamic range of adjustments support the full range of seated postures from active forward-leaning to recline
- High performance sure-lock footring with 20" diameter (on stool heights)
- Supports up to 300 lbs.
- 10-Year, Three-Shift Warranty
- Rhino Chair has SCS Indoor Advantage Gold Certification and may help contribute toward LEED certification.

### CONSTRUCTION:

- 26" fiberglass-reinforced nylon base
- Integrated steel arm structure with metal-to-metal connections eliminates points of failure
- Class 4 pneumatic cylinder: 1.12" diameter with a 17-4 taper top end for maximum strength

### OPTIONS:

- Arms: an intensive use fixed arm option; an adjustable arm option (height range of 6"-10" above seat, inside width range of 19.5"-23"); or a fully articulating arm option w/ slide (adds 3 locking pivot positions, and 2.5" of travel front to back).
- Casters: universal dual wheel is standard. A variety of other casters are also available.
- Rounded footring is standard. Flat surface (mid and high heights only) or fixed (desk height only) are also available.
- Desk, mid, high, and extended range heights
- Small back available for tight workspaces
- Painted or polished aluminum base
- Available only in black
- Class 10 or 100 cleanroom options

### DIMENSIONS:

MODEL#	MAXIMUM OVERALL DIMENSIONS		SEAT DIMENSIONS		SEAT HEIGHT FROM FLOOR WHEN SEATED E	BACK DIMENSIONS		WEIGHT LBS.
	A	B	C	D		F	G	
RHSD3	32.75	27.50	18.25	16.75	15.75 - 21.00	15.00	10.00	29
RHSM3	40.25	27.50	18.25	16.75	20.50 - 28.00	15.00	10.00	34
RHSH3	45.25	27.50	18.25	16.75	22.25 - 32.75	15.00	10.00	35
RHMD3	36.75	27.50	18.25	16.75	15.75 - 21.00	16.25	15.50	32
RHMM3	44.25	27.50	18.25	16.75	20.5 - 28.00	16.25	15.50	36
RHMH3	49.00	27.50	18.25	16.75	22.25 - 32.75	16.25	15.50	37

Dimensions listed in inches.  
Adding arms will increase weight by 10 lbs.  
Measurements are for standard mechanisms and can vary +/- .5".

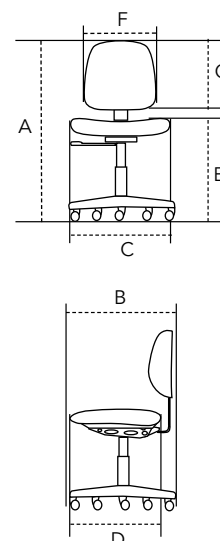

## PRICING:

Chair Style	Back Size	Adjustment Mechanism	Model Number	list price (only available in black)
	small back	3 Way	RHSD3	\$545
		4 Way	RHSD4	\$640
	medium back	3 Way	RHMD3	\$578
		4 Way	RHMD4	\$666
	small back	3 Way	RHSM3	\$628
		4 Way	RHSM4	\$714
	medium back	3 Way	RHMM3	\$670
		4 Way	RHMM4	\$755
	small back	3 Way	RHSH3	\$641
		4 Way	RHSH4	\$727
	medium back	3 Way	RHMH3	\$682
		4 Way	RHMH4	\$768

3 Way - Seat Height, Back Depth, Back Height  
4 Way - Seat Height, Back Height, Back Angle, Seat Angle

## OPTIONS:

ORDER CODE	LIST PRICE	ORDER CODE	LIST PRICE
<b>CASTERS</b>			
		<b>universal dual wheel.....standard*</b>	
1.	carpeted floor only .....	n/c	
3.	non-rolling glide .....	n/c	
7.	weight activated brakes when not seated .....	\$66	
9.	weight activated brakes when seated.....	\$110	
10.	hard surface single wheel with 3" diameter .....	\$66	
<b>ARMS</b>			
b.	adjustable arms .....	\$160	
t.	articulating arms w/slide .....	\$177	
a.	intensive use fixed arms .....	\$180	
<b>FOOTRINGS</b>			
		<b>high performance rounded footring .....standard*</b>	
x.	high performance flat surface footring .....	\$38	
c.	fixed footring (desk height only) .....	\$44	
<b>ENVIRONMENTS</b>			
p.	cleanroom.....	\$65	
<b>EXTRAS</b>			
d.	painted aluminum base .....	\$53	
e.	polished aluminum base .....	\$78	
m.	extended range cylinder (approx. 19"-29") (cylinder upcharge added to high-height price).....	\$12	

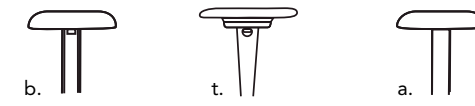

\*Standard casters and footrings included unless different options are requested.

## HOW TO ORDER:

MODEL NUMBER	TEXTILE CODE*	AVAILABLE OPTIONS CODE
<input type="text"/>	<input type="text"/>	<input type="text"/>

\*Refer to Cramer Textile Offering for code. (COM priced at Grade 1)

# RHINO® ROUND STOOL

**10**  
year  
THREE-SHIFT  
WARRANTY



Rhino®Round Stool is the durable choice for higher education. Its self-skinned urethane resists punctures, tears, and virtually all spills and cleans easily. This model is also available in three heights, making it easy to concentrate on the job at hand.

## SPECIFICATIONS:

### FEATURES:

- Perfect all-around stool for tight work spaces.
- Rhino skin resists chemical and physical damage
- Hand or foot-activated height adjustment, accessible from any direction
- High performance sure-lock footring with 20" diameter (on hand-activated stool heights)
- Supports up to 300 lbs.
- 10-Year, Three-Shift Warranty

### OPTIONS:

- Casters: universal dual wheel is standard. A variety of other casters are also available.
- Rounded footring is standard. Flat surface is also available. Footrings are only available on hand-activated, mid and high-height stools.
- Desk, mid, high, and extended range heights
- Available only in black
- Painted or polished aluminum base
- Class 10 or 100 cleanroom options

### CONSTRUCTION:

- 23" fiberglass-reinforced nylon base (hand-activated); 23" die-cast aluminum base (foot-activated)
- Self-skinned Rhino urethane seat
- Class 4 pneumatic cylinder
- Heat-bonded powder coat finish

### DIMENSIONS:

MODEL#	MAXIMUM OVERALL DIMENSIONS		SEAT DIMENSIONS C	SEAT HEIGHT FROM FLOOR WHEN SEATED D	WEIGHT LBS.
	A	B			
RROD1	20.00	24.50	15.00	15.25 - 20.50	19
RROM1	27.25	24.50	15.00	20.00 - 27.25	23
RROH1	32.75	24.50	15.00	22.00 - 32.00	24
RROF1	22.00	24.50	15.00	16.75 - 21.75	23
RROG1	28.50	24.50	15.00	20.75 - 28.00	25

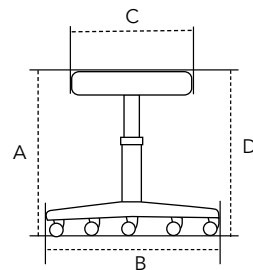

Dimensions listed in inches.

# RHINO® ROUND STOOL

## PRICING:

Chair Style	Activation Type	Adjustment Mechanism	Model Number	list price (available only in black)
 desk-height	hand	1 Way	RROD1	\$295
	foot	1 Way	RROF1	\$536
 mid-height	hand	1 Way	RROM1	\$375
	foot	1 Way	RROG1	\$554
 high-height	hand	1 Way	RROH1	\$387

1 Way Adjustment - Seat Height

## OPTIONS:

ORDER CODE	LIST PRICE	ORDER CODE	LIST PRICE
<b>CASTERS</b>		<b>ENVIRONMENTS</b>	
	<b>universal dual wheel.....standard*</b>	p.	cleanroom .....\$65
1.	carpeted floor only .....n/c	<b>EXTRAS</b>	
3.	non-rolling glide .....n/c	d.	painting aluminum base (standard on foot-activated models).....\$53
7.	weight-activated brakes when not seated .....\$66	e.	polished aluminum base.....\$78
9.	weight-activated brakes when seated .....\$110	m.	extended range cylinder (approx. 19"-29") (cylinder upcharge added to high-height price).....\$12
10.	hard surface single wheel with 3" diameter .....\$66		
<b>FOOTRINGS</b>			
	<b>high performance rounded footring .....standard*</b>		
x.	high performance flat surface footring .....\$38		
c.	fixed footring (desk height only) .....\$44		

\*Standard casters and footrings included unless different options are requested.

Option m is available on hand-activated models only.

## HOW TO ORDER:

MODEL NUMBER	TEXTILE CODE*	AVAILABLE OPTIONS CODE
<input type="text"/>	<input type="text"/>	<input type="text"/>
*Refer to Cramer Textile Offering for code. (COM priced at Grade 1)		

# RHINO® SIT/STAND

**10**  
year  
THREE-SHIFT  
WARRANTY



The Rhino®Sit/Stand is designed for people who work standing up. Not intended as a place to sit, the Rhino Sit/Stand is a lean or perch, providing periods of relief that help keep productivity high to the end of the shift.

## SPECIFICATIONS:

### FEATURES:

- Flexible seat adjusts for comfortable sit.
- Molded Rhino skin resists chemical and physical damage
- Adjustable tension control allows users to select a customized level of support
- Accommodates sit/stand position
- Flex pressure adjusts to user weight
- Height adjustable to fit different users
- Supports up to 300 lbs.
- 10-Year, Three-Shift Warranty

### OPTIONS:

- Glides available with five-star base. Casters are not available.
- 26" painted or polished aluminum base
- Available only in black
- Class 10 or 100 cleanroom options

### CONSTRUCTION:

- Black aluminum 21" trumpet base or 23" fiberglass-reinforced nylon five-star base
- Self-skinned urethane seat

### DIMENSIONS:

MODEL#	MAXIMUM OVERALL DIMENSIONS		SEAT DIMENSIONS		SEAT HEIGHT FROM FLOOR WHEN SEATED E	WEIGHT LBS.
	A	B	C	D		
STOH1	37.00	21.00	14.25	14.25	24.00 - 31.00	22
SSOH1	35.00	23.00	14.25	14.25	22.00 - 32.00	22

Dimensions listed in inches.  
Measurements are for standard mechanisms and can vary +/- .5".

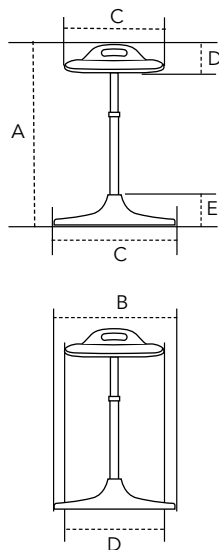

# RHINO® SIT/STAND

## PRICING:

Chair Style	Base Style	Adjustment Mechanism	Model Number	list price (only available in black)
high-height	trumpet	1 Way	STOH1	\$541
	five-star	1 Way	SSOH1	\$421

1 Way Adjustment - Seat Height

## OPTIONS:

ORDER CODE	LIST PRICE
<b>ENVIRONMENTS</b>	
p. cleanroom.....	\$65
<b>EXTRAS</b>	
d. painted aluminum base .....	\$53
e. polished aluminum base .....	\$78

## HOW TO ORDER:

MODEL NUMBER	TEXTILE CODE*	AVAILABLE OPTIONS CODE
<input type="text"/>	<input type="text"/>	<input type="text"/>

\*Refer to Cramer Textile Offering for code. (COM priced at Grade 1)

# DIMENSION™

**10**  
year  
SINGLE-SHIFT  
WARRANTY



Finally - a chair designed specifically for petite individuals or tight workspaces. Dimension™ has a shorter seat depth that accommodates your legs, and its solid construction outlasts any average chair on the block.

## SPECIFICATIONS:

### FEATURES:

- Ergonomically proportioned to comfortably fit smaller individuals and tighter workspaces.
- Solid construction guarantees years of support
- Contoured molded seat with waterfall edge ensures 24-hour comfort
- Dynamic range of adjustments support the full range of seated postures from active forward-leaning to recline
- High performance sure-lock footring with 20" diameter (on stool heights)
- Supports up to 300 lbs.
- 10-Year, Single-Shift Warranty
- Dimension has SCS Indoor Advantage Gold Certification and may help contribute toward LEED certification

### CONSTRUCTION:

- 23" fiberglass-reinforced nylon base
- Integrated steel arm structure
- High resiliency flame-retardant 3" thick seat foam with a density of 2.4 lbs. per cubic foot

- Class 4 pneumatic cylinder: 1.12" diameter with a 17-4 taper top end for maximum strength
- Heat-bonded powder coat finish

### OPTIONS:

- Arms: an intensive use fixed arm option; an adjustable arm option (height range of 6"-10" above seat, inside width range of 19.5"-23"); or a fully articulating arm option w/ slide (adds 3 locking pivot positions, and 2.5" of travel front to back).
- Casters: universal dual wheel is standard. A variety of other casters are also available.
- Rounded footring is standard. Flat surface (mid and high heights only) or fixed (desk height only) are also available.
- Desk, mid, high, and extended range heights
- Painted or polished aluminum base
- TB 133 Fire Code
- Class 100 Cleanroom, ESD, or CR/ESD Combination

### DIMENSIONS:

MODEL#	MAXIMUM OVERALL DIMENSIONS		SEAT DIMENSIONS		SEAT HEIGHT FROM FLOOR WHEN SEATED E	BACK DIMENSIONS		WEIGHT LBS.
	A	B	C	D		F	G	
DMSD2	36.00	24.50	18.00	17.00	16.75 - 22.25	17.00	12.00	27
DMSM2	43.50	24.50	18.00	17.00	21.25 - 28.75	17.00	12.00	32
DMSH2	48.50	24.50	18.00	17.00	23.00 - 33.5	17.00	12.00	33
DMMD2	38.00	24.50	18.00	17.00	16.75 - 22.25	16.25	14.75	31
DMMM2	45.50	24.50	18.00	17.00	21.25 - 28.75	16.25	14.75	36
DMMH2	50.50	24.50	18.00	17.00	23.00 - 33.5	16.25	14.75	37

Dimensions listed in inches.  
Adding arms will increase weight by 10 lbs and can increase overall height and seat height by .25" - 1".  
Measurements are for standard mechanisms and can vary +/- .5".

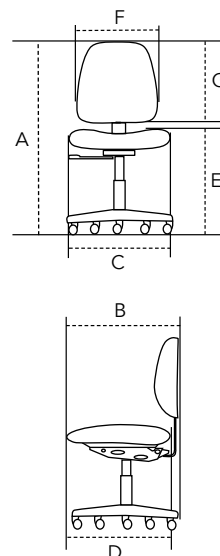

# DIMENSION™

## PRICING:

Chair Style	Back Size	Adjustment Mechanism	Model Number	List prices by textile grades (see textile card for styles)						ESD*
				1	2	3	4	5	6	
	small back	2 Way	DMSD2	\$556	572	588	604	620	636	693
		4 Way	DMSD4	\$645	661	677	693	709	725	782
		6 Way	DMSD6	\$708	724	740	756	772	788	845
	medium back	2 Way	DMMD2	\$593	609	625	641	657	673	730
		4 Way	DMMD4	\$683	699	715	731	747	763	820
		6 Way	DMMD6	\$745	761	777	793	809	825	882
	small back	2 Way	DMSM2	\$632	648	664	680	696	712	769
		4 Way	DMSM4	\$721	737	753	769	785	801	858
	medium back	2 Way	DMMM2	\$663	679	695	711	727	743	800
		4 Way	DMMM4	\$753	769	785	801	817	833	890
		2 Way	DMSH2	\$670	686	702	718	734	750	807
			DMSH4	\$758	774	790	806	822	838	895
4 Way	DMMH2	\$688	704	720	736	752	768	825		
	DMMH4	\$777	793	809	825	841	857	914		

2 Way - Seat Height, Back Depth  
4 Way - Seat Height, Back Height, Back Angle, Seat Angle  
6 Way - Seat Height, Back Height, Back Angle, Seat Angle, Chair Tilt, Forward Tilt Limiter

\*Must indicate ESD textile code AND option code q below for chair to perform as ESD

## OPTIONS:

ORDER CODE	LIST PRICE	ORDER CODE	LIST PRICE
<b>CASTERS</b>		<b>FOOTRINGS</b>	
<b>universal dual wheel.....standard*</b>		<b>high performance rounded footing .....standard*</b>	
1. carpeted floor only.....n/c		x. high performance flat surface footing.....\$38	
3. non-rolling glide.....n/c		c. fixed footing (desk height only).....\$44	
7. weight activated brakes when not seated.....\$66		<b>ENVIRONMENTS</b>	
9. weight activated brakes when seated.....\$110		n. TB 133.....\$91	
10. hard surface single wheel with 3" diameter.....\$66		p. cleanroom (must choose a vinyl).....\$90	
<b>ARMS</b>		q. ESD (must choose ESD textile).....\$230	
b. adjustable arms.....\$160		r. cleanroom/ESD (must also choose ESD vinyl).....\$260	
t. articulating arms w/slide.....\$177		<b>EXTRAS</b>	
a. intensive use fixed arms.....\$180		d. painted aluminum base.....\$53	
		e. polished aluminum base.....\$78	
		k. upholstered back.....\$39	
		m. extended range cylinder (approx. 19"-29") (cylinder upcharge added to high-height price).....\$12	

\*Standard casters and footrings included unless different options are requested.

## HOW TO ORDER:

MODEL NUMBER	TEXTILE CODE*	AVAILABLE OPTIONS CODE
<input type="text"/>	<input type="text"/>	<input type="text"/>

\*Refer to Cramer Textile Offering for code. (COM priced at Grade 1)

# CENTRIS™

**10**  
year  
SINGLE-SHIFT  
WARRANTY



Centris™ applies Cramer's durability standards and attention to detail to office seating. For single-shift applications, our comprehensive warranty and solid construction make Centris an easy choice.

## SPECIFICATIONS:

### FEATURES:

- Solid construction guarantees years of support.
- Contoured molded seat with waterfall edge ensures comfort
- Dynamic range of adjustments support the full range of seated postures from active forward-leaning to recline
- High performance sure-lock footring with 20" diameter (on stool heights)
- Supports up to 300 lbs.
- 10-Year, Single-Shift Warranty
- Centris has SCS Indoor Advantage Gold Certification and may help contribute toward LEED certification.

### OPTIONS:

- Arms: an intensive use fixed arm option; an adjustable arm option (height range of 6"-10" above seat, inside width range of 19.5"-23"); or a fully articulating arm option w/ slide (adds 3 locking pivot positions, and 2.5" of travel front to back).
- Casters: universal dual wheel is standard. A variety of other casters are also available.
- Rounded footring is standard. Flat surface (mid and high heights only) or fixed (desk height only) are also available.
- Desk, mid, high, and extended range heights
- Painted or polished aluminum base
- TB 133 Fire Code
- Class 100 Cleanroom, ESD, or CR/ESD Combination

### CONSTRUCTION:

- 26" fiberglass-reinforced nylon base
- Integrated steel arm structure
- High resiliency flame-retardant 3" thick seat foam with a density of 2.4 lbs. per cubic foot.
- Class 4 pneumatic cylinder: 1.12" diameter with a 17-4 taper top end for maximum strength
- Heat-bonded powder coat finish

### DIMENSIONS:

MODEL#	MAXIMUM OVERALL DIMENSIONS		SEAT DIMENSIONS		SEAT HEIGHT FROM FLOOR WHEN SEATED E	BACK DIMENSIONS		WEIGHT LBS.
	A	B	C	D		F	G	
CEMD2	36.75	27.50	20.00	19.00	16.50 - 22.00	16.25	14.75	33
CEMM2	44.25	27.50	20.00	19.00	21.00 - 28.50	16.25	14.75	38
CEMH2	49.25	27.50	20.00	19.00	22.75 - 33.25	16.25	14.75	39
CELD2	38.75	27.50	20.00	19.00	16.50 - 22.00	17.50	19.00	38
CELM2	46.25	27.50	20.00	19.00	21.00 - 28.50	17.50	19.00	43
CELH2	51.25	27.50	20.00	19.00	22.75 - 33.25	17.50	19.00	44

Dimensions listed in inches.  
Adding arms will increase weight by 10 lbs and can increase overall height and seat height by .25" - 1".  
Measurements are for standard mechanisms and can vary +/- .5".

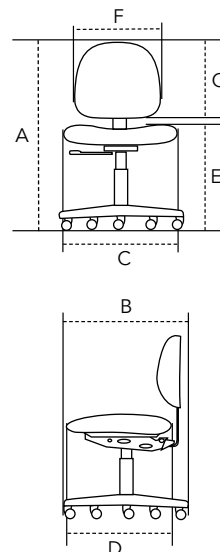

# CENTRIS™

## PRICING:

Chair Style	Back Size	Adjustment Mechanism	Model Number	List prices by textile grades (see textile card for styles)						ESD*
				1	2	3	4	5	6	
	medium back	2 Way	CEMD2	\$569	585	601	617	633	649	706
		4 Way	CEMD4	\$656	672	688	704	720	736	793
		6 Way	CEMD6	\$720	736	752	768	784	800	857
	large back	2 Way	CELD2	\$606	622	638	654	670	686	743
		4 Way	CELD4	\$696	712	728	744	760	776	833
		6 Way	CELD6	\$758	774	790	806	822	838	895
	medium back	2 Way	CEMM2	\$645	661	677	693	709	725	782
		4 Way	CEMM4	\$732	748	764	780	796	812	869
	large back	2 Way	CELM2	\$683	699	715	731	747	763	820
		4 Way	CELM4	\$771	787	803	819	835	851	908
	medium back	2 Way	CEMH2	\$688	704	720	736	752	768	825
		4 Way	CEMH4	\$777	793	809	825	841	857	914
large back	2 Way	CELH2	\$708	724	740	756	772	788	845	
	4 Way	CELH4	\$796	812	828	844	860	876	933	

2 Way - Seat Height, Back Depth  
4 Way - Seat Height, Back Height, Back Angle, Seat Angle  
6 Way - Seat Height, Back Height, Back Angle, Seat Angle, Chair Tilt, Forward Tilt Limiter

\*Must indicate ESD textile code AND option code q below for chair to perform as ESD

## OPTIONS:

ORDER CODE	LIST PRICE	ORDER CODE	LIST PRICE
<b>CASTERS</b>		<b>FOOTRINGS</b>	
<b>universal dual wheel.....standard*</b>		<b>high performance rounded footring .....standard*</b>	
1. carpeted floor only.....n/c		x. high performance flat surface footring .....	\$38
3. non-rolling glide .....	n/c	c. fixed footring (desk height only) .....	\$44
7. weight activated brakes when not seated .....	\$66	<b>ENVIRONMENTS</b>	
9. weight activated brakes when seated.....	\$110	n. TB 133 .....	\$91
10. hard surface single wheel with 3" diameter .....	\$66	p. cleanroom (must choose a vinyl).....	\$90
<b>ARMS</b>		q. ESD (must choose ESD textile) .....	\$230
b. adjustable arms .....	\$160	r. cleanroom/ESD (must also choose ESD vinyl) .....	\$260
t. articulating arms w/slide .....	\$177	<b>EXTRAS</b>	
a. intensive use fixed arms .....	\$180	d. painted aluminum base .....	\$53
		e. polished aluminum base .....	\$78
		k. upholstered back.....	\$39
		m. extended range cylinder (approx. 19"-29") (cylinder upcharge added to high-height price).....	\$12

\*Standard casters and footrings included unless different options are requested.

## HOW TO ORDER:

MODEL NUMBER	TEXTILE CODE*	AVAILABLE OPTIONS CODE
<input type="text"/>	<input type="text"/>	<input type="text"/>

\*Refer to Cramer Textile Offering for code. (COM priced at Grade 1)

## Kik-Step®

	Model Number	No. of Steps	Overall Height	Weight	Carton Cu. Ft.	UPS	List Price
	1001	2	14"	10 lbs.	1.3	Yes	\$105
	Classic: Silvertone (01), Orange Zest (30), White (14), Buff (19), Fire Engine Red (43), Copper (61), Celery (55), Midnight Blue (63), Charcoal Gray (82), Black (92)						
	1002	2	14"	10 lbs.	1.3	Yes	\$139
	Premium Grade Stainless Steel						
	1003	2	14"	10 lbs.	1.3	Yes	\$105
50th Anniversary Library Edition: Black (92), Silvertone (01)							

## Steel Folding Ladder™

	Model Number	No. of Steps	Overall Height	Weight	Carton Cu. Ft.	UPS	List Price
	1130	3	33 3/8"	26 lbs.	5.03	Yes	\$319
	Beige (19)						

## Scooter Seat™

	Model Number	No. of Steps	Overall Height	Weight	Carton Cu. Ft.	UPS	List Price
	1014	0	14 1/2"	11 lbs.	0.57	Yes	\$99
	Red (43), Winter Gray (82), Silvertone (01)						



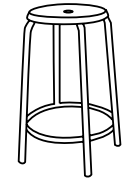

## PAL™ Step Stool

	Model Number	No. of Steps	Overall Height	Weight	Carton Cu. Ft.	UPS	List Price
	2011	1	9"	5 lbs.	1.22	Yes	\$75
	Black (92), Silvertone (01)						

## Stationary Steel Stool™

	Model Number	No. of Steps	Overall Height	Weight	Carton Cu. Ft.	UPS	List Price
	TA12	Low	18"	10 lbs.	0.65	Yes	\$99
	TA22	Medium	24"	11 lbs.	0.81	Yes	\$109
	TA32	High	30 1/4"	12 lbs.	1.00	Yes	\$119
	Winter Gray (82) only						

## Stop-Step™ Ladders

	Model Number	No. of Steps	Top Step Height	Carton Weight	Overall* Height	Width	Depth	Carton Cu. Ft.	UPS	List Price
No Handrail 	1020	2	18"	13 lbs.	23 1/4"	21 1/4"	20 1/4"	3.09	Yes	\$389
	1030	3	27"	17 lbs.	32 1/2"	21 1/2"	26 1/2"	4.51	Yes	\$469
	1040	4	36"	29 lbs.	41 1/2"	24 1/2"	34"	9.82	Yes	\$559
Right Handrail 	1031R	3	27"	25 lbs.	57"	21 1/2"	27"	4.87	Yes	\$599
	1041R	4	36"	33 lbs.	66"	24 1/2"	34"	9.82	Yes	\$699
	1051R	5	45"	38 lbs.	74 1/2"	25"	40 3/4"	11.5	No	\$899
Left Handrail 	1031L	3	27"	25 lbs.	57"	21 1/2"	27"	4.87	Yes	\$599
	1041L	4	36"	33 lbs.	66"	24 1/2"	34"	9.82	Yes	\$699
	1051L	5	45"	38 lbs.	74 1/2"	25"	40 3/4"	11.5	No	\$899
Double Handrail 	1033	3	27"	27 lbs.	57"	21 1/2"	27"	4.87	Yes	\$629
	1043	4	36"	32 lbs.	66"	24 1/2"	34"	9.82	Yes	\$739
	1053	5	45"	44 lbs.	74 1/2"	25"	40 3/4"	15.88	No	\$949
	1063	6	54"	45 lbs.	84"	26"	47"	14.58	No	\$1199
Yellow (10), Beige (19), Winter Gray (82)										
*Note: Overall height includes the top of the handrail.										

Please allow \$45.00 surcharge for all orders under four units that can not be shipped via UPS. All ladders ship knocked down. Please refer to [www.cramerinc.com](http://www.cramerinc.com) to see paint color samples.

## Adjust to task for productivity and ergonomics

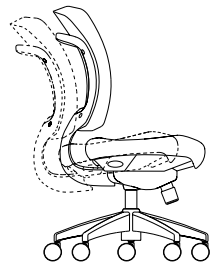

**SYNCHRO TILT**  
Provides a smooth, comfortable ride. With 1.7 degrees of back recline for every one degree of seat recline, assumes a broad range of seated positions.

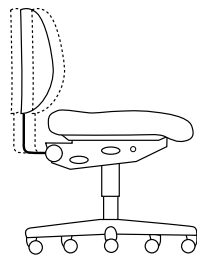

**BACK DEPTH**  
Backrest slides in and out and locks in numerous positions to allow additional room between the seat cushion and the backrest.

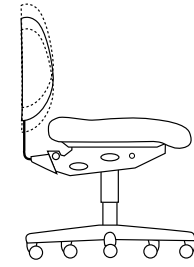

**BACK HEIGHT**  
Backrest slides up and down and locks in place through either a locking wheel adjustment or a finger-touch ratcheting adjustment (also known as lumbar adjustment).

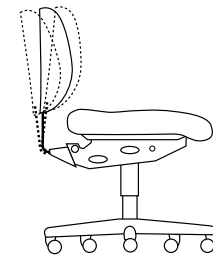

**BACK ANGLE**  
Backrest pivots forward and back, independent of seat angle. Locks at desired angle.

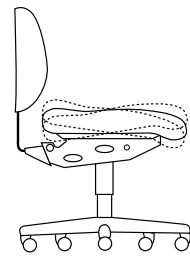

**SEAT ANGLE**  
Seat tilts forward and back. Locks at desired angle.

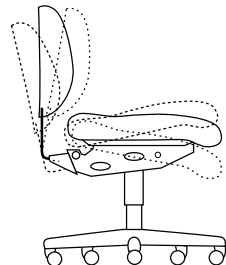

**CHAIR TILT**  
Chair (seat and back together) tilts forward and back. Allows chair to rock when seat angle is unlocked.

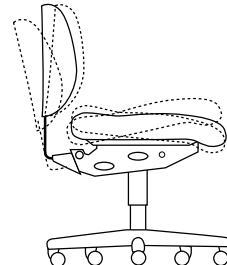

**FORWARD TILT LIMITER**  
When engaged, prevents full forward tilt and/or rocking. Convenient function for many tasks.

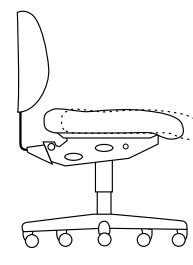

**SEAT SLIDER**  
Seat slides forward and back. Locks in desired position. Important way to adjust leg support for different sized users.

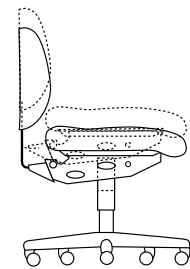

**SEAT HEIGHT**  
Chair can be raised or lowered to numerous heights.

### To find the right chair height:

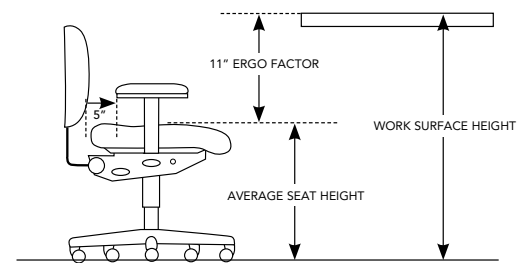

Measure the work surface height and subtract the 11 inch ergo factor = ideal average seat height  
note: Extra low cylinder available on most models for \$58 upcharge.

## Arm option details

	HEIGHT	WIDTH	PIVOT (3 locking positions)	SLIDING ARM PAD (2.5" of travel front to back)
adjustable arms	x	x		
articulating arm with slide	x	x	x	x
intensive use fixed arms				
ever adjustable arms	x			

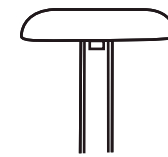

adjustable arms

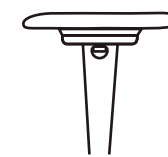

articulating arm w/slide

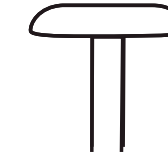

intensive use fixed arms

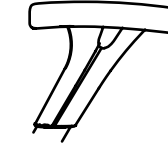

ever adjustable arms

## Caster option details

Our Universal Dual Wheel caster is our standard caster. Other options are available for unique work environments.

Caster Description	Application	Available for ESD
<b>Universal dual wheel</b>	General purpose for all surfaces	Yes
1. Carpeted only dual wheel caster	General purpose for carpet applications	No
3. Universal Glide	This is a pad, not a wheel, use on any floor surface	Yes
7. Weight-activated locks when not seated caster	Caster will roll only when you are seated	Yes
9. Weight-activated locks when seated caster	Caster will roll only when you are not seated	Yes
10. Hard surface with 3" diameter	General purpose for hard surface; adds 1" to height	No

Universal

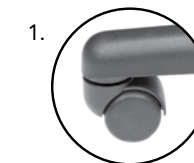
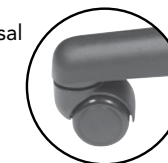

1.



3.

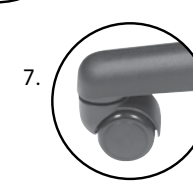

7.

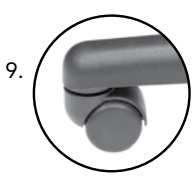

9.



10.

# Cramer Shipping/Ordering Information

**5-Day lead-time:** Cramer starts building your product as soon as your order has been accepted. The 5 working day lead-time program includes most products, fabric, and options from current price book. For orders greater than 30 units, please call Customer Service for a current build schedule.

(Configurations not shown may require additional time.)

**Authorized Dealers:** Cramer works with authorized dealers to ensure the very best service and information. Call Cramer for an authorized dealer in your area. Possession of this price list does not constitute authority to sell products contained in this price list.

**To Order:** Please include the following with every order: purchase order number, quantity, model number, caster, upholstery and option code selection. In order to avoid errors or duplication, Cramer requires all purchase orders to be faxed, emailed or mailed. Your order is not considered binding until it has been accepted and acknowledged by Cramer.

**Ordering Replacement Parts:** Cramer can supply replacement seats, backs, casters, glides and other component parts. Please call Customer Care for additional information.

Additions or changes: Orders placed for 5-day lead-times are produced immediately and no changes or cancellations can be made. On extended lead-time orders, a written request must be submitted to add to, or make changes to, an order. This may affect your shipping date. Charges for changes or additions may apply as follows:

20 or more working days before shipping date	No Charge
15 to 19 working days before shipping date	20% of order value
5 to 15 working days before shipping date	70% of order value
Less than 5 working days before shipping	No changes or additions

## SHIPPING

**Shipping Charges:** List prices include freight to any point within the contiguous 48 states. For orders shipped to locations outside of the continental US freight is included only to the port of embarkation. Most products are shipped knocked down (KD). Easy assembly – no tools required.

**Specialty shipping:** For an additional charge, you can request the following: fully assembled product, inside on-site delivery, on-site assembly or on-site installation. Call 1-800-366-6700 for a quote.

**Claims for damage during shipping:** Cramer uses freight carrier approved packaging materials and carefully handles all products. When your order arrives, please examine each item and note damages or shortages on your delivery receipt. If the shipping box is damaged, note this also. If you discover damage that was concealed, you must report it to the freight carrier and Cramer within 15 days of delivery.

To order by email: [orders@cramerinc.com](mailto:orders@cramerinc.com)

**Returns:** All products are built to order. Products may be returned only with Cramer approval. You must put your MRA (Material Return Authorization) number on the outside of any returned package. Returned goods will be subject to a restocking charge and Cramer reserves the right to deny credit for any damages.

**Standard terms of sale:** 1% 10 days or net 30 days from the date of invoice. Credit approval required. Larger orders may require a down payment.

## PRODUCT DESIGN

Cramer reserves the right to make changes in design and construction or discontinue products without prior notice. All dimensions are to be considered approximate. Weights shown are packaged weight and do not include optional accessories.

Prices are subject to change without notice.

## WARRANTY

This warranty applies only to products used under normal conditions by the original purchaser. Warranties do not apply to damage from neglect, abuse, normal wear and tear, or to products that have been modified by the user. Cramer supplied replacement parts must be used to retain warranty coverage.

Fabric, foam assembly and arm pads are warranted for three (3) years. The urethane skin and foam assembly on Rhino products are warranted for five (5) years.

Labor charges for repairs performed outside of the factory, or for installation of replacement parts, is the responsibility of the purchaser.

Cramer's liability is limited to repair or replacement, at Cramer's option, and cannot exceed the original invoice price. All labor charges must be pre-approved. Cramer is not liable for incidental or consequential damage arising in connection with the sale, use or serviceability of Cramer products. Repairs or replacements do not extend the original warranty period.

For warranty claims, contact Cramer Customer Care at 1-800-366-6700. For the fastest service, have the information from the label under the seat ready. This helps us to determine when the chair was manufactured and other specific details necessary to respond to your questions. This warranty is in lieu of other warranties expressly stated or implied.

For questions about our warranty, please call Customer Care at 1-800-366-6700.

# Cramer ESD

CRAMER CHAIRS CONTROL STATIC ELECTRICITY

Cramer ESD chairs are designed to meet the ESD Association standard test method for the Protection of Electrostatic Discharge Susceptible Items-Seating-Restive Measurement standard ESD STM12.1-1997. This includes testing of the seat, backrest, rear of backrest, armrest (if applicable), footrest (if applicable), and base. NOTE: A conductive outer back is standard only on Triton family models. All other models require an upholstered outer back option to comply with ESD standard STM12.1-1997.

The chair frame, from the back to the base, is electrically conductive to ensure static charges will be dissipated through the upholstery and the chair frame to floor grounds. Conductive casters and glides available in black only. Frame finish is black.

Upholstery is ESD vinyl or 100% nylon fabric material specially woven with conductive fibers and backcoated with a conductive medium. Special conductive materials are installed in contact with the upholstery materials and the chair frame, ensuring immediate dissipation of static charges. Prior to shipment, Cramer tests each ESD chair for conductive quality.

ESD option includes polished aluminum base, chrome barrel and dual wheel casters (when hard surface is selected)

To order a Cramer ESD chair choose an ESD grade textile and order option code "Q".

# Cramer Fire Code

For seating there are two main flammability codes in use in the United States:

- California Technical Bulletin 117 – (TB117)
- California Technical Bulletin 133 – (TB133)

## TB117

All Cramer chairs pass TB117. Components used in seating, such as foam and fabric, are tested individually for flammability characteristics. This is a minimum standard for all furniture offered for sale in California. Cramer is not responsible for Customers Own Material (COM) upholstery fire code compliance.

## TB133

Most Cramer chairs can be manufactured to meet the more stringent TB133. TB133 requires that a fully upholstered seating unit, not just its components, pass a full-scale open flame burn test. TB133 recreates conditions typical of real fires and is by far the most difficult and comprehensive flammability test. It is mandatory for certain public occupancies. Contact your local Fire Marshall for local code requirements.

To pass TB133, Cramer products feature specially formulated foam, flame retardant upholstery and a flame barrier material. Grade 1 through Grade 6 fabric or vinyl may be ordered. Cramer is not responsible for COM upholstery compliance.

To order TB133 choose option code "N".

# Cramer Cleanroom

Cramer cleanroom chairs are designed for minimal particulate contribution as certified by tests conducted in accordance with ASTM F25-68 and SAE ARP734A. Air introduced into the test chamber is filtered through 99.99% effective, .5 micron filters. The test chamber is subject to simulated usage by depressing the cushions while a discrete-particle counter records the particulate count. Cramer offers Cleanroom seating products manufactured to meet FED STD 209E (ISO/TC209) in Class 10 (ISO4) and 100 (ISO5):

Class 10: Rhino, Rhino Round Stool, Rhino Sit/Stand

Class 100: Triton, TritonMax, TritonPlus, RhinoPlus, RhinoPlus Round Stool, Fusion, Round Stool, Dimension, Centris

All exposed metal frame components are chrome plated or powder epoxy coated. To prevent present and future contamination, all footings are sealed with MIG-welds. Seat heights are achieved by sealed, contaminate-free pneumatic cylinders.

Components, such as upholstered seats and backs, are protected from contamination during shipment in sealed plastic bags. Cleanroom chairs are labeled with instructions for unpacking in a cleanroom prep area.

To order a Cramer Cleanroom chair choose a vinyl textile or urethane product and choose option code "p".

# Cramer & the Environment

Corporate and environmental stewardship are priorities at Cramer. It is part of our mission statement, evident in every chair and stool in our seating product line, and recognized by SCS Gold certifications.

## Environmental Stewardship

We are committed to conduct business in a manner that protects our natural environment and embraces the principals of sustainability and environmental stewardship. We continue to invest in better materials, methods, and manufacturing practices to enhance sustainability and care of the environment.

## SCS Gold Certification

The entire line of Cramer seating products is certified SCS Indoor Advantage™ Gold in North America. The criteria for achieving this industry environmental standard are established by BIFMA and the US Green Building Council.

CUSTOMER CARE  
1-800-366-6700  
E-MAIL: [info@cramerinc.com](mailto:info@cramerinc.com)



**Cramer, LLC.** 1222 Quebec Street, North Kansas City, MO 64116  
customer service 1.800.366.6700 fax 1.800.607.2821 [www.cramerinc.com](http://www.cramerinc.com)